

DAWN 40

design: Marco Merendi / 2014

KUNDALINI

Lampada da parete e da soffitto. Riflettore in metallo verniciato bianco opaco e corpo illuminante in metallo con finitura rame lucido o cromo o nero.

Wall and ceiling lamp. Matt white painted metal reflector and polish copper or black chrome metal luminaire body.

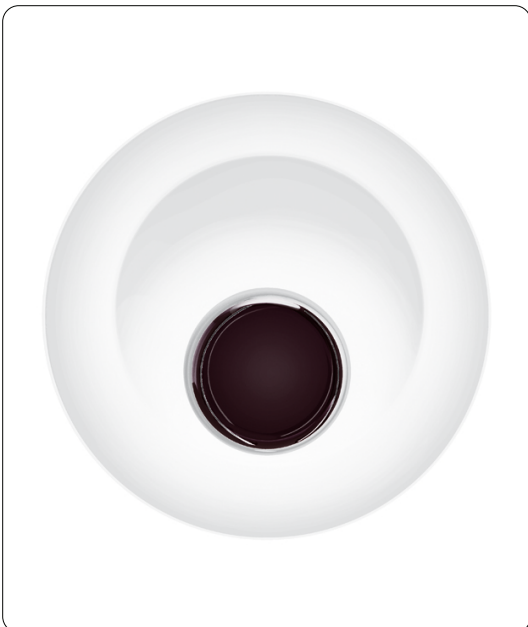

CERTIFICAZIONI - CERTIFICATIONS



Apparecchio di classe I
Product in class I

IP20

Apparecchio per uso interno
Product for indoor use



Apparecchio conforme alla direttiva europea 2006/95/EC
Product in conformity with the European directive 2006/95/EC



Apparecchio di illuminazione da smaltire secondo la direttiva EU 2002/96/EC
This lamp must be disposed in conformity with the EU directive 2002/96/EC

DIMENSIONI - DIMENSIONS

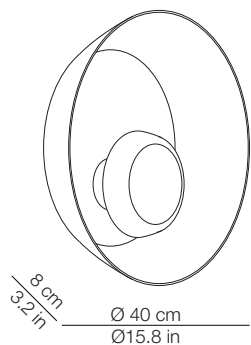

IMBALLO - PACKAGING

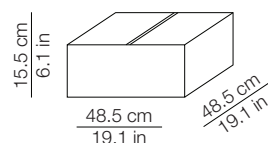

Volume: 0.036 m³ / 1.288 ft³
Gross weight: 4.3 kg / 9.4 lbs

MATERIALI E FINITURE - MATERIALS AND FINISHINGS

corpo illuminante
luminaire body

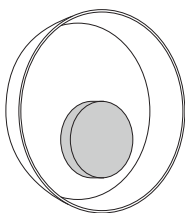

corpo illuminante in metallo con finitura rame lucido o cromo nero
polished copper or black chrome metal luminaire body



rame lucido
polished copper



cromo nero
black chrome

bianco - white
RAL 9010



riflettore
reflector

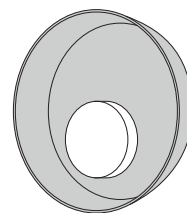

riflettore in metallo verniciato bianco opaco
matt white painted metal reflector

INFORMAZIONI AGGIUNTIVE - FURTHER INFORMATION

230V
or
120V

Alimentazione
Feeding

Lampadine - *Bulbs*
1 x 17W - 2700K - 1500lm - CRI>80 - Board led



Energy efficiency class A+

Lampada da parete e soffitto
Wall and ceiling lamp

